



## BUILT-IN TRASH CONTAINER

### Model #53825-T

**INSTALLER:** Leave these instructions with consumer.  
**CONSUMER:** Retain for future reference.



To install your trash container, follow the steps below:

1. Make sure the opening for your trash container matches the cutout dimensions shown.
- Note:** It is recommended that silicon caulking (not supplied) is applied around the back of the unit's trim before installing it into the opening.
2. Slide the unit into the opening.
  3. Open the trash container door by stepping on the pedal. Remove the bin. To remove the door, pull it completely out. Release the door from the door slides by pressing the 2 black levers up on the left side, and down on the right side. (With the lever pressed, the slide will need to be pushed back to unlock.) After all 4 slides are unlocked, pull the door completely off. Locate the 3 screw holes found on the left and right sides of the unit. Secure the unit using  $1/8$ " by  $3/4$ " fastening screws (not supplied) that are appropriate for the enclosure framework.
  4. Re-attach the door by extending the door slides completely and aligning the door into the slides, pushing the door closed. Open the door to verify it has locked in place. Replace the bin.
  5. If desired; attach the kick guard (included in the package) by peeling off its backing and applying it to the bottom of the door. Reference Fig. 1-1 for location. Be sure to clean the area accordingly prior to application. Please note that the kick guard is designed for permanent installation.

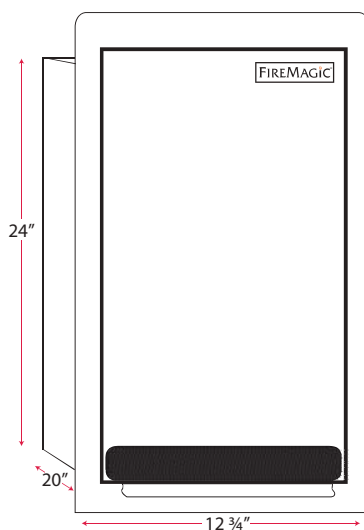

**Fig. 1-1** Cutout dimensions

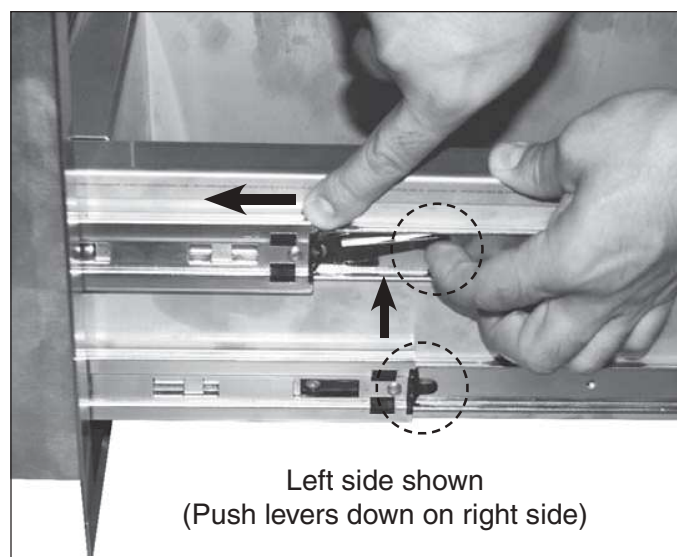

**Fig. 1-2** Door removal